

## VloX GTE

Ultra thin fingerprint access control terminal with time attendance feature.



VloX GTE is an ultra-thin fingerprint access control terminal with SilkID sensor and time attendance features, which offers unparalleled performance with advanced algorithm for reliability, precision and excellent matching speed.

VloX GTE features the fastest commercial-based fingerprint matching algorithm and high-performance, high-image quality infrared detection fingerprint sensor.

VloX GTE provides a superior touching experience with touch keypad and offers flexibility for standalone installation or with any third-party access control panel that supports standard wiegand signal.

Connection for LAN, WiFi and RS485 are also available so the device can be used in different types of network.

VloX GTE Available in black and white versions with keypad backlight on both versions.

### Features

- 2.4-inch TFT color screen and Touch keys
- Ultra-thin and elegant design
- Full Access Control Features:
  - Anti-passback, access control interface for 3rd party electric lock, door sensor, exit button, alarm
  - Standard Wi-Fi
- Network interface by TCP/IP or RS485
- Built-in auxiliary input with enhanced flexibility to link to wired detector or emergency switch
- Multiple Verification Modes with card as optional providing user various choices

### Specifications

|                          |  |
|--------------------------|--|
| Display                  | 2.4-inch TFT LCD Color Screen  |
| Fingerprint Capacity     | 3000   |
| Card Capacity            | 5000 EM or mifare card   |
| Transaction Capacity     | 30,000   |
| Sensor                   | SilkID Sensor  |
| Algorithm Version        | VX10.0   |
| Communication            | RS232/485, TCP/IP, USB-host,Wi-Fi  |
| Access Control Interface | 3rd Party Electric Lock, Door Sensor, Exit Button, Alarm   |
| Wiegand Signal           | Input, Output  |
| Aux. Input               | 1ea for linkage function (outside BEM50 fingerprint reader)  |
| Functions                | DST, Automatic Status Switch, Record query, T9 input, 14 digit user ID, Anti-passback, Scheduled-Bell, Printer(Optional), ADMS(Optional) |
| Power Supply             | 12V DC,3A  |
| Operating Temperature    | 0 °C- 45 °C - indoor use only  |
| Operating Humidity       | 20%-80%  |
| Dimension(LxWxH)         | 158.5x78.0x19.4mm  |
| SDK and software         | Standalone or VloX AMS software  |

### Optional Accessories



BEM50 / BMF50



SEB relay



VloX AMS software

### Configuration

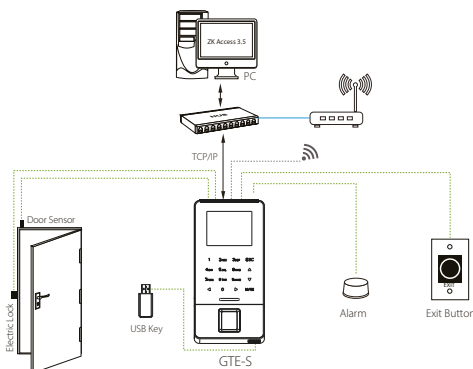

### Dimensions (mm)

